

  
**ASPEN**  
POWER CATAMARANS

**C120**



# STANDARD EQUIPMENT

- Volvo D6 330HP common rail diesel engine with 4" display
- (2) 15,000 BTU air conditioners or Wallace furnaces (1) 30Dt (1) 40Dt
- Side Power, bow and stern thrusters w/ joy stick control
- 6kW Kohler Generator
- Force 10 LPG 3 burner stainless steel propane stove & oven, and 1000W microwave
- 6 automatic hull bilge pumps, 1 engine compartment crash pump, 2,000gph w/ alarm
- Side-by-side NovaKool fridge and freezer - low power draw design
- (4) AGM 6V house batteries (450 amp hours), and (4) AGM 12V batteries for the engine, generator, electronics, & stern thruster
- Blue Seas 12V and 120V panels with amp and volt meters
- Liquid Industries wire harnesses
- 1-1/2" stainless rails bow, and cockpit, welded and electro polished
- Large 12.5' X 8' aft cockpit and oversized deck trails 14" and 8"
- Amtico Teak and Holly cabin sole (commercial grade), staterooms and heads solid teak soles with polished DuraTech finish
- Wine glass holder above galley
- Dual Bentley's Yachtsman Rivermaster helm seats with Ultra Leather, dual density
- Lumitec LED lighting throughout





# ASPEN C120

3 STATEROOMS • 2 HEADS



## DESIGN FEATURES

*Aspen Power Catamarans are meticulously designed and crafted to give flawless performance on demand. To do so, they hold up to incredible harsh environments, withstanding the powerful forces of nature. Aspen Catamarans are built to the highest standards of quality and strength.*

- TaylorMade frameless marine windshield, Diamond Seaglace mirror SolarGuard side windows with opening, glass door and folding bulkhead window (all tempered glass)
- Kevlar reinforced bows and keel
- Full keel with stainless steel sand bar for protecting the prop, shaft, and rudder
- Premium vinyl ester /ISO composites
- Armorcoat ISO NPG gel coat, UV stabilized (Ultra Premium)
- Island King - Full 13'6" beam stateroom, private head, teak cabinets and drawers P&S
- Queen Stateroom with teak hanging locker, skylight, three windows, and private head
- Two heads with Dometic toilets, glass bowl sinks, full showers with handholds and teak grates, vanity, port light windows, and skylight in the starboard head
- Custom Corian counters in galley and heads
- Fold up cockpit bulkhead window with table and two swinging out stool seats



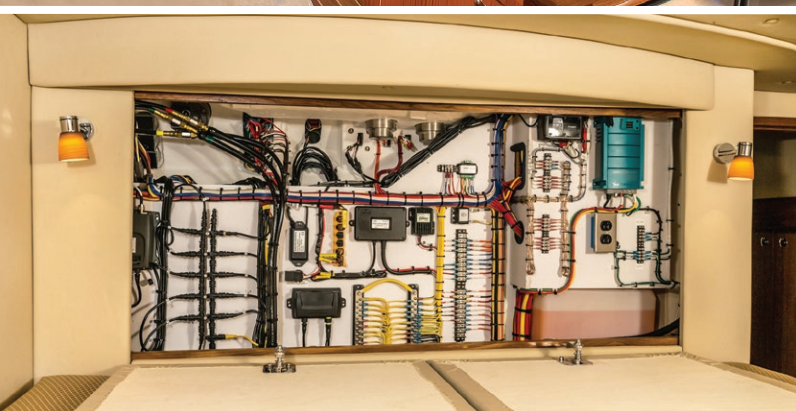

## QUALITY ABOVE & BELOW

From lamination materials to interior components, Aspen chooses the highest quality materials, such as solid hand-crafted Burmese Teak cabinetry, tables and flooring. All cross beams, bulkheads, transoms, and stringers are constructed from CNC cut Coosa composite ranging in thickness from  $\frac{3}{4}$ " to  $2\frac{1}{2}$ ", guaranteed for life. Coosa is a polyurethane and fiberglass reinforced panel that is 45% lighter than plywood; it is waterproof and cannot decay. The uniquely engineered integrated rib, stinger, bulkhead system is solidly fiber glassed in place to carry a catamaran's unique loads. A hand lay-up process utilizes a combination of premium knitted fiberglass materials, yielding the maximum strength with the least amount of weight.

Hull lamination starts with the best UV stabilized gelcoat. CCP's, Armorcote Isophthalic-NPG gelcoat, it provides superior UV resistance that displays the high gloss quality seen in our boats. This is followed by a skin of 2 oz. mat with pure vinyl ester resin. This resin is 20% stronger and is a complete water barrier. It eliminates any possible blistering above or below the waterline. The following lamination is done with high strength Isothalic polyester resin and includes multiple layers of 18 oz. roving (long fibers that go the entire length of hull), 1.5 oz. mat, 3mil and 6mil Coremat in specific areas, knitted bi-axial fiberglass fabric,  $\frac{3}{4}$ " PVC Divinycell foam, and Kevlar. This is used to develop strength and structure as needed. The bottom of the hull is reinforced by 3 additional layers of mat and roving, along with a double layer of Divinycell. Total thickness of the double bottom is just over  $2\frac{1}{2}$ ". The entire hull and deck are bonded with aircraft grade cross linked urethane adhesive, then fastened with 316 SS fasteners every 3". Finally, the inside of the deck-hull joint is fiber glassed with 1708 Nytex.

Aspen is proudly NMMA certified, but clearly the build quality goes above and beyond the minimum of industry standards. Great pride is taken in the system installations using Cobra wiring and class K tinned copper wire that's manufactured in Michigan, USA. Electrical systems are paired with industry leading Blue Seas components from Bellingham, WA. All plumbing and wiring runs are clearly labeled and installation is done with pride and perfection; as if works of art.

The first step to buying is to share your dreams with the Aspen Team. Aspen uses an in-depth design brief to help define your vision and to document your priorities for your new boat. A personal visit to the Aspen factory is recommended to learn how your boat will be constructed and to witness the true value of Aspen. You will experience the craftsmanship and attention to detail, only found with Aspen.



# BOSA PACKAGE

*Featuring white interior with custom Ultra Leather accents, custom 4" higher dash and centered helm wheel, dark teak, bonded polished stainless boat name, swimstep bustle removed.*





# EXTERIOR OPTIONS



Flybridge; 8 person seating, custom upholstery choices, drawer fridge, subwoofer, polished teak table with compass rose inlay



Sail Shade



Aft cockpit ice box with 2" insulation



Solar Panel Brow, (4) 100W panels, Solar Boost 3,000 charger, folding radar arch, bimini top and canvas cover



Dual wench davit, center console dinghy with 20hp Honda

# MECHANICAL OPTIONS



Volvo D6 435 and additional 110 amp house bank alternator



Underwater lights on port and starboard hull



# INTERIOR OPTIONS



**Garmin** Electronics Package (shown): 7612xsv GPS MAP, 7616 display, 7612 display, 600w CHIRP Transducer, GMR 24" Fantom xHD Doppler Radar, GHP 20 Auto Pilot Kit with wireless remote, AIS 600 (transponder send/receive), GMI 52 Weather Kit



Custom Corian counters and backsplash, large basin sink



Custom Ultra Leather and reclining dinette seats



## FLYBRIDGE



## UPPER DECK

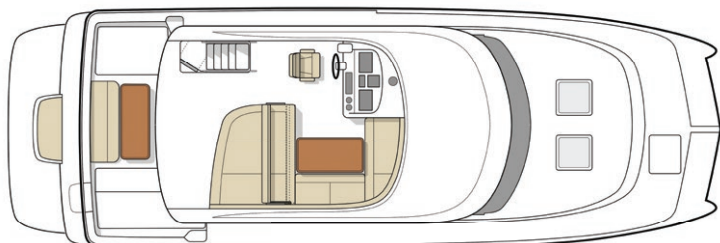

## MAIN DECK

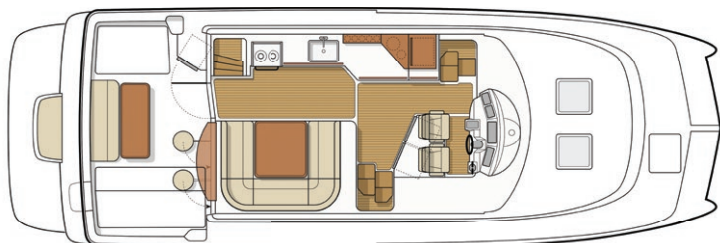

## LOWER DECK

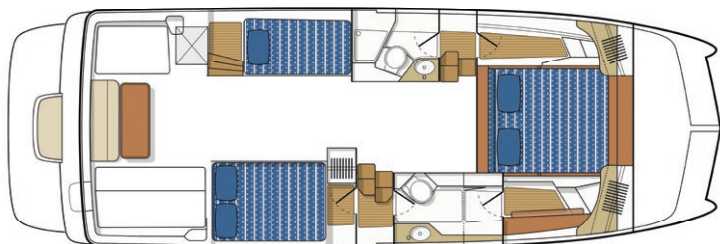

# Aspen C120 MotorYacht

## SPECIFICATIONS

LOA	42'6"	12.95m
BEAM	13'10"	4m
DRAFT	39"	.99m
DISPLACEMENT	22,500lb.	10,200kg
STANDARD HP	Volvo D6	330hp
FUEL	180 G.	681 L.
WATER	100 G.	378 L.
WASTE	80 G.	303 L.
CLEARANCE (arch up)	18'6"	5.6m
CLEARANCE (arch down)	12'7"	3.8m



Master Stateroom with King Mattress; 13'6"W x 12'L x 6'6"H

## C120 PERFORMANCE

Volvo 435

	RPM	MPH Up	MPH Down	MPH Average	GPH Average	MPG	Kts MPG	220 Gallon Range	Cruising Hours
	600	3.6	3.6	3.60	0.3	10.9	9.3	2160.0	636.4
	1000	6.1	6.1	6.10	0.8	7.9	6.7	1568.6	272.7
	1500	9.1	9.1	9.10	2.1	4.4	3.7	862.1	100.5
	2000	11.0	11.6	11.30	5.4	2.1	1.8	415.1	39.0
	2500	17.6	17.4	17.50	9.3	1.9	1.6	372.8	22.6
	3000	23.0	22.7	22.85	15.4	1.5	1.3	293.8	13.6
	3500	25.3	24.9	25.10	18.7	1.3	1.1	265.8	11.2
	3530	27.7	26.6	27.15	24.2	1.1	1.0	222.1	8.7

### Conditions:

Prop # 2652 40M --- 23.00 X 20.00 CR4B 2.00" Bore, .010Cup, 4.5" Hub Length, .75 DAR

Wind 5-10 Mph

Fuel 1/2 tank 110 gallons

Passengers 2/430lbs

Gear 400

Est Gross wt. 19,900

By Larry G. 5/17/2015

Notes: Second Test with 4 Blade Prop

\*Completed boat with Flybridge

\*When tested with 10 people, approx. 2,000lbs additional weight, top speed was 26.7mph

w/10% Reserve w/10% Reserve

